

RIZE
BTRIZETWSK
BTRIZETWSW

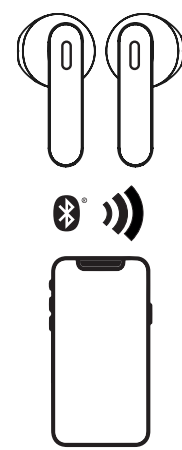
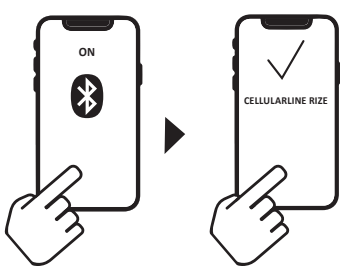
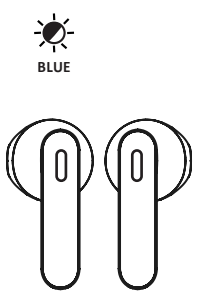
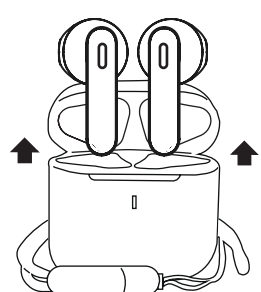
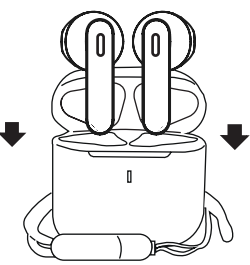
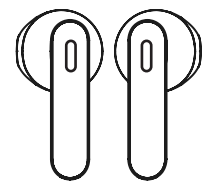
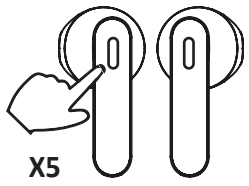
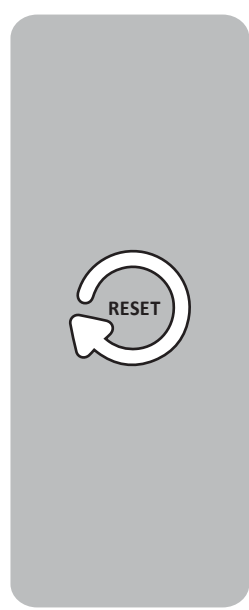
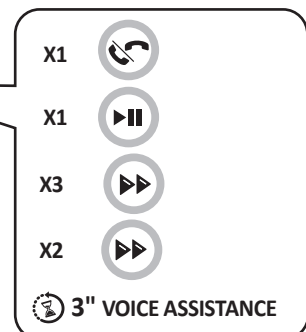
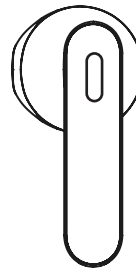
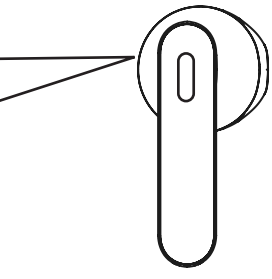
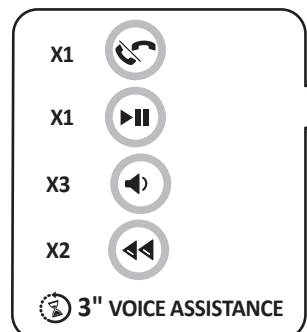
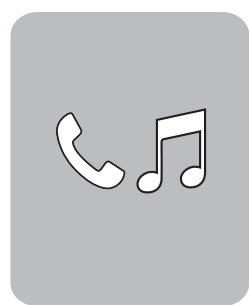
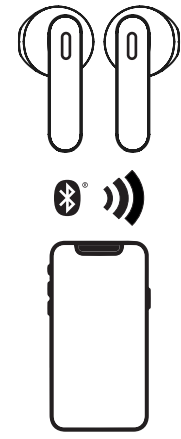
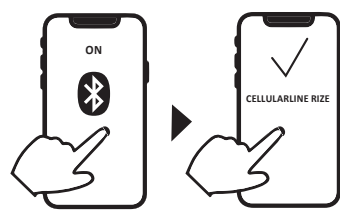
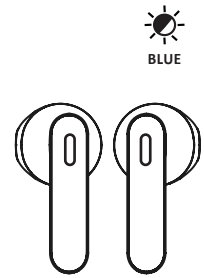
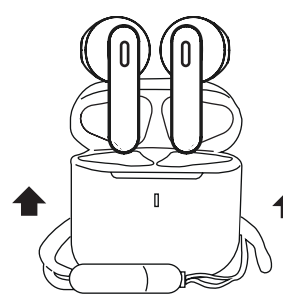
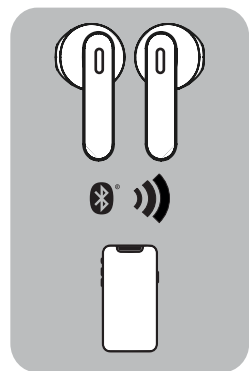
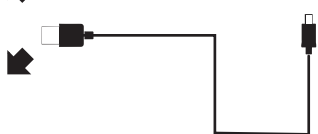
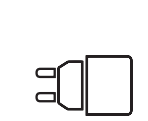
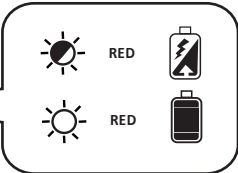
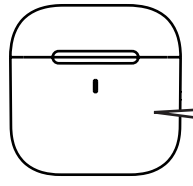
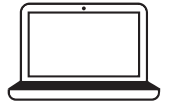
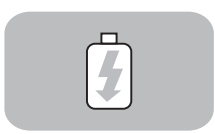

EN - Technical specifications:
 Bluetooth® / version: 5.3
 Supported profiles: Headset - Handsfree - A2DP - AVRCP
 Range / metres: 10
 Bluetooth® Frequency Range / Mhz: 2402-2480
 Battery Voltage / Volt: 3.7
 Battery capacity / mAh: 250
 Charging Case Battery Capacity / mAh: 250
 USB-C port Voltage (V) / Volt: 5
 USB-C port current (A) / Ampere: 1
 Maximum EIRP: 5W
 SAR: 3W
 Standby Time / hours/ approx.: 30
 Talk Time / hours/ approx.: 5
 Play Time / hours/ approx.: 5
 Earphone charging / hours/ approx.: 1
 Charging Case / hours/ approx.: 1.5
 Weight / grams: 28

IT - Specifiche tecniche:
 Bluetooth® / versione: 5.3
 Profili supportati: Headset - Handsfree - A2DP - AVRCP
 Portata / metri: 10
 Bluetooth® Frequenza Range / Mhz: 2402-2480
 Batteria Voltage / Volt: 3.7
 Batteria Capacità / mAh: 250
 Charging Case Battery Capacity / mAh: 250
 USB-C port Voltage (V) / Volt: 5
 USB-C port current (A) / Ampere: 1
 Maximum EIRP: 5W
 SAR: 3W
 Standby Time / ore-circa: 30
 Talk Time / ore-circa: 5
 Play Time / ore-circa: 5
 Ricarica auricolari / ore-circa: 1
 Ricarica Charging Case / ore-circa: 1.5
 Peso / grammi: 28

FR - Caractéristiques techniques:
 Bluetooth® / version : 5.3
 Profils supportés : Headset - Mainfree - A2DP - AVRCP
 Portée / mètres : 10
 Bluetooth® Gamme de fréquences / Mhz : 2402-2480
 Tension de la batterie / Volt : 3.7
 Capacité de la batterie / mAh : 250
 Capacité de la batterie du Charging Case / mAh : 250
 Tension du port USB-C (V) / Volt : 5
 Courant du port USB-C (A) / Ampère : 1
 PIRE max : 5W
 DAS : 3W
 Autonomie en stand-by / heures (environ) : 30
 Autonomie en conversation / heures (environ) : 5
 Autonomie en lecture / heures (environ) : 5
 Recharge des écouteurs / heures (environ) : 1
 Recharge du Charging Case / heures (environ) : 1.5
 Poids / grammes : 28

DE - Technische Daten:
 Bluetooth® / Version: 5.3
 Unterstützte Profile: Headset - Handsfree - A2DP - AVRCP
 Reichweite / Meter: 10
 Bluetooth®-Frequenzbereich / Mhz: 2402-2480
 Akkuspannung / Volt: 3.7
 Akkukapazität / mAh: 250
 Charging Case Akkukapazität / mAh: 250
 USB-C-Anschluss Spannung (V) / Volt: 5
 USB-C-Anschluss Strom (A) / Ampere: 1
 Maximum EIRP: 5W
 SAR: 3W
 Standby Time / Stunden ca.: 30
 Gesprächszeit / Stunden ca.: 5
 Musikwiedergabezeit / Stunden ca.: 5
 Aufladen Headset / Stunden ca.: 1
 Aufladen Charging Case / Stunden ca.: 1.5
 Gewicht / Gramm: 28

ES - Especificaciones técnicas:
 Bluetooth® (versión): 5.3
 Perfiles admitidos: Headset - Handsfree - A2DP - AVRCP
 Alcance (metros): 10
 Rango de frecuencia Bluetooth® (MHz): 2402-2480
 Voltaje de la batería (voltios): 3.7
 Capacidad de la batería (mAh): 250
 Capacidad de la batería del Charging Case (mAh): 250
 Voltaje del puerto USB-C (voltios): 5
 Corriente del puerto USB-C (amperios): 1
 Potencia isotrópica radiada equivalente máxima (EIRP): 5W
 Tasa de absorción específica: 3W
 Tiempo en reposo (horas aprox.): 30
 Tiempo de conversación (horas aprox.): 5
 Tiempo de reproducción (horas aprox.): 5
 Recarga de los auriculares (horas aprox.): 1
 Recarga del Charging Case (horas aprox.): 1.5
 Peso (gramos): 28

TR - Teknik özellikler:
 Bluetooth® / sürümü: 5.3
 Desteklenen profiller: Headset - Elbir Serbest - A2DP - AVRCP
 Kapsama alanı / metre: 10
 Bluetooth® Frekans Aralığı / Mhz: 2402-2480
 Pili Voltajı / Volt: 3.7
 Pili Kapasitesi / mAh: 250
 Charging Case Pili Kapasitesi / mAh: 250
 USB-C port Gerilimi (V) / Volt: 5
 USB-C port akımı (A) / Amper: 1
 Maksimum EIRP: 5W
 SAR: 3W
 Bekleme Süresi / yaklaşık - saat: 30
 Konuşma Süresi / saat-yaklaşık: 5
 Çalma Süresi / saat-yaklaşık: 5
 Kulak içi kulaklıkların yeniden şarj edilmesi / saat-yaklaşık: 1
 Charging Case Yeniden Şarj Edilmesi / saat-yaklaşık: 1.5
 Ağırlık / gram: 28

NL - Technische kenmerken:
 Bluetooth® / versie: 5.3
 Ondersteunde profielen: Headset - Handsfree - A2DP - AVRCP
 Bereik / meter: 10
 Bluetooth® Frequentiebereik / Mhz: 2402-2480
 Batterijspanning / Volt: 3.7
 Batterijcapaciteit / mAh: 250
 Batterijcapaciteit oplaadcase / Volt: 250
 Spanning USB-C-poort (V) / Volt: 5
 Stroomsterkte USB-C-poort (A) / Ampère: 1
 Maximum EIRP: 5W
 SAR: 3W
 Stand-by Time / uur-circa: 30
 Tijdsduur in gesprek / uur-circa: 5
 Afspeltijd / uur-circa: 5
 Oplaaftijd headset / uur-circa: 1
 Oplaaftijd oplaadcase / uur-circa: 1.5
 Gewicht / gram: 28

FI - Tekniset tiedot:
 Bluetooth® / versio: 5.3
 Tuettu profiilit: Headset - Handsfree - A2DP - AVRCP
 Kantavuus / metri: 10
 Bluetooth® taajuusalue / Mhz: 2402-2480
 Akun jännite / Volt: 3.7
 Akun kapasiteetti / mAh: 250
 Charging Case-latausotelon akun kapasiteetti / mAh: 250
 USB-C-portin jännite (V) / Voltti: 5
 USB-C-portin virta (A) / Ampeeri: 1
 Maksimi EIRP: 5W
 SAR: 3W
 Standby-aika / tuntia-noin: 30
 Puhe aika / tuntia-noin: 5
 Musiikkunteluaika / tuntia-noin: 5
 Kuulokkeiden lataaminen / tuntia-noin: 1
 Charging Case-latausotelon lataaminen / tuntia-noin: 1.5
 Paino / grammaa: 28

SV - Tekniska specifikationer:
 Bluetooth® / version: 5.3
 Profiler som stöds: Headset - Handsfree - A2DP - AVRCP
 Räckvidd / meter: 10
 Bluetooth® frekvensvidd / Mhz: 2402-2480
 Batterispanning / Volt: 3.7
 Batterikapacitet / mAh: 250
 Batterikapacitet laddningsfodral / mAh: 250
 USB-C-portens spänning (V) / Volt: 5
 USB-C-portström (A) / Ampere: 1
 Maximal EIRP: 5W
 SAR: 3W
 Standbytid / timmar cirka: 30
 Samtalstid / timmar cirka: 5
 Speltid / timmar cirka: 5
 Laddning av hörlurar / timmar cirka: 1
 Laddning av laddningsfodral / timmar cirka: 1.5
 Vikt / gram: 28

